

# LC-SRA-LOOP

## Strain Relief Installation Guide

*freedom in lighting*

**1. Lock the bottom part to the driver so that it clicks into place.**

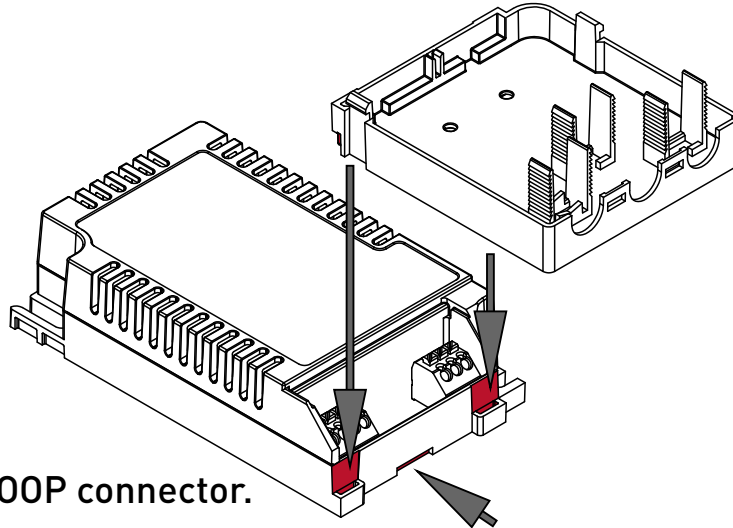

**2. Connect the LOOP connector.**

I. Connect short wires into LOOP connector (depending on the amount of input terminals in LED driver).

II. Connect short wires from LOOP connector into correct terminals.

III. Lock the connector firmly into place.

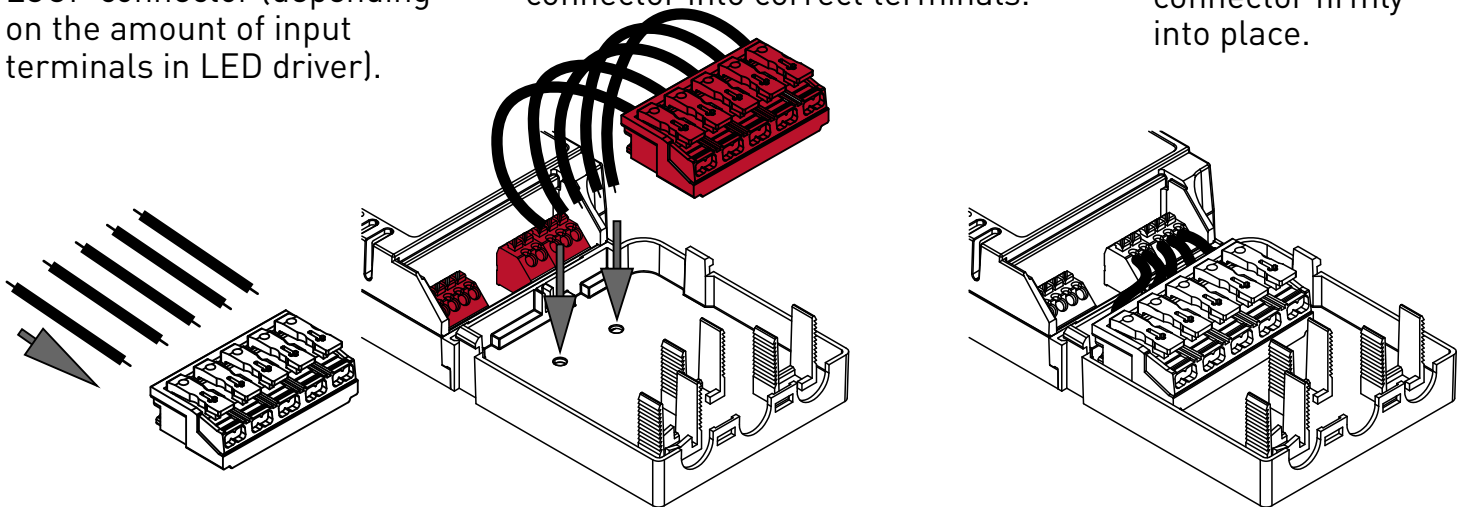

**3. Connect wires into correct terminals according to driver datasheet instructions, both into LOOP connector and into LED load connector.**

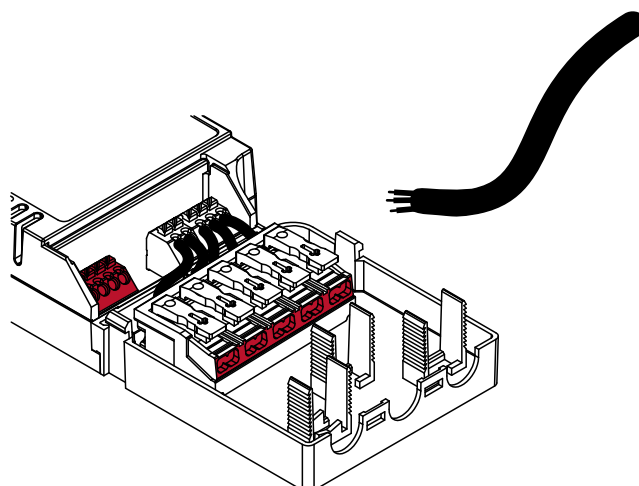

**NOTE:** with Active+ drivers, please use product code LC-SRA-LOOP-2WIRE, which has 3-pole LOOP connector.

Continues on the next page 

# LC-SRA-LOOP

## Strain Relief Installation Guide

*freedom in lighting*

### 4. Lock wires with the cable clamps.

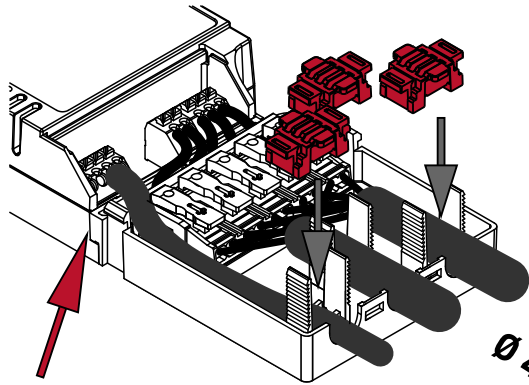

Ensure that cables are tightly locked.  
It's recommended to use tool  
to push the clamp

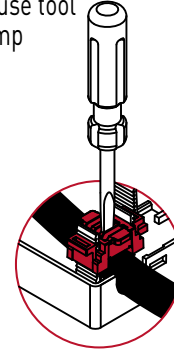

Check connections once more  
after locking the clamps!

Ø 4,8 - 12,5 mm  
Ø 4,8 - 12,5 mm  
Ø 3 - 10 mm

### 5. Lock the cover on the bottom part.

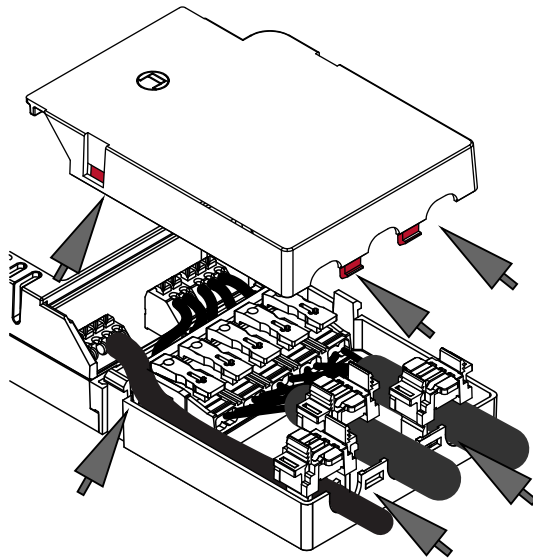

Pay attention that  
the cover clicks  
into place properly!

